



BARCLAY TUCK
YACHTS



AB YACHTS 110' 2025

Discover the epitome of luxury and performance with the AB 110' 2025, a masterpiece of Italian craftsmanship. This semi-displacement motor yacht, designed by the renowned Marco Casamonti of Studio Archea, combines breathtaking aesthetics with cutting-edge technology. This vessel redefines elegance on the water.

Key Features

- **Impressive Performance:** Powered by Three MAN V12-2000 Engines (2000 HP each) and MJP Waterjets, the AB 110 Achieves a Maximum Speed of 41 knots and a Cruising Speed of 35 knots. A Gyroscopic Seakeeper 26 Stabilizer Ensures Smooth Sailing at Anchor and Underway.
- **Spacious Dimensions and Shallow Draft:** 110' LOA x 22' 3" Beam and with a 4' 3" Draft the AB effortlessly Glides into Secluded Coves, Pristine Bahamian Waters, and Other Shallow Destinations that Other Yachts Can't Reach.
- **Luxurious Accommodations:** Sleeps up to 8 guests in 4 elegant cabins (Master Stateroom, VIP and two Guest Staterooms with Sliding Beds). Crew quarters accommodate 4 in two cabins.
- **Premium Interiors:** Exclusive Interior Designer Premium Package and Electric Blind Curtains Enhance the Sophisticated Ambiance.
- **State-of-the-Art Navigation:** Four Garmin 24" Ultrawide & Two Garmin 28" Ultrawide Monitors, Garmin Radar GMR Phantom, Chart Plotter, and Simrad Autopilot. Starlink Predisposition and 5G Wi-Fi Ensure Seamless Connectivity.
- **Outdoor Living:** Expansive Sun Deck, Flybridge with Teak Flooring, and Aft Deck all with JL-Audio Waterproof Speakers and Lighting. Party Mode available replicating the settings of the main salon, merging the AV on the Flybridge, Aft Deck, Main and Lower Deck.
- **Advanced Amenities:** 180,000 BTU Condaria Air Conditioning, 47 Gallons/Hour Watermaker and a Tender Garage for a 14' Tender and Jet Ski (not included). Ten RGBW Underwater Lights Illuminate the Transom and Sides.

Additional Highlights

- **Galley & Appliances:** Equipped with Miele Oven, Bora Cooking Top, Liebherr Wine Cooler, and Raritan Ice maker. Crew Mess Includes Washer, Dryer, and Fridge.
- **Customization:** Dark Metallic Paint, CarbonFire Staircase, and Stainless Steel Rub-Rail Elevate the Yacht's Sleek Profile.
- **Certifications:** R.I.Na Class C HULL • MACH Y – Unrestricted Navigation (Pleasure Yacht).
- **Awards:** Winner of the World Superyacht Awards 2025 (Semi-Displacement or Planing Motor Yachts, 30m-39.9m) and World Yacht Trophies 2024 for Best Exteriors

Why Choose the AB 110?

The AB 110' 2025 is a rare blend of speed, style, and sophistication, perfect for discerning owners seeking unforgettable experiences on the open water. With a shallow 4'3" draft, it effortlessly accesses secluded destinations like the Bahamas, where larger yachts can't venture. Its award-winning design and robust engineering make it a standout in the luxury yacht market.

Price: With an asking price of €15,650,000, this exceptional vessel offers the chance for an incredible deal, as the motivated seller is eager to entertain reduced offers from serious buyers.

Location: Currently located in Italy, the AB 110 is ready for you to enjoy a luxurious summer cruising the Mediterranean before being easily shipped to the US or wherever your yachting adventures may take you.

Contact us today to schedule a private viewing or request additional details. Don't miss the opportunity to own this exceptional vessel!



GENERAL DETAILS

Make:	AB YACHTS	Price:	€15,650,000	Location:	Viareggio, Italy
LOA:	110'	Beam:	22' 3"	Draft:	4' 3"
Staterooms:	(4) Four + Crew	Heads:	(5) Five + Crew	AC:	Condaria 180,000 BTU
Gensets:	(2) Kohler 32 kW	Bow Thruster:	Side Power 320Kg, 220V	Voltage:	400V, Three-Phase + Neutral, 60Hz
Engines:	(3) MAN V12-2000	Jets:	(2) MJP Steerable (1) MJP Central Booster	Speed:	Cruise - 35 Knots Max - 41 Knots
Fuel:	3,038 Gallons	Fresh Water:	528 Gallons	Displacement:	242,508 lbs



Specifications

MAIN SALON

- Two Blue Modular Sofas
- Teak Floor Throughout
- Dining Table for Eight
- Bar/Galley
- Day Head

GALLEY

- Miele Oven 23.6"
- Bora Cooktop
- Sink
- Miele Dishwasher
- Liebherr Wine Cooler (About 30 Bottles)
- (2) Small Liebherr Refrigerators
- Liebherr Freezer
- Raritan Ice Maker

ACCOMMODATIONS

- Full Beam Master Stateroom with EnSuite
- VIP Double Stateroom with EnSuite
- (2) Guest Twins with Slidable Beds & EnSuites

CREW

- (2) Cabins (Sleeps 4) Each with Head & Shared Shower
- Miele Washer
- Miele Dryer
- Miele Microwave
- Frigonautica Fridge

GARAGE TENDER CAPACITY

- Tender 14' (tender not included)
- Jet Ski (3-Seat Personal Water Craft Not Included)

IT AND WI-FI

- Peplink MAX BR1 Mini LTEA Router - Wi-Fi - Worldwide for Marina Hotspot Communications
- Ubiquiti Dream Machine Pro Router Wireless Controller, Firewall
- Ubiquiti with 48 POE Switch for All Physical Ethernet Connections
- (5) Ubiquiti Access Point UniFi 6 Long-Range 3000 Mbit/s PoE (distributed across all decks)
- (2) Scan Antenna Marine & Coastal Wi-Fi Gain 9dBi
- LAN and WiFi NETWORK: 5G System

Audio-Visual System

MAIN SALON

- Samsung Smart TV 65" 4K Qled
- HDMI & USB Wall Plate
- Streaming: Netflix, Disney+, etc via Smart TV & Spotify via Marantz Cinema 60 Amplifier
- (7) Dynaudio P4-W65 Rectangular Speaker 6,5"
- JL-Audio Home Subwoofer 8" d108
- Apple TV 4K with IP control
- Apple iPad Mini 6 64GB Wi-Fi (Crestron Configured)

MASTER STATEROOM

- Samsung Smart TV Led 55" 4K
- HDMI & USB Wall Plate
- Streaming: Netflix, Disney+, etc via Smart TV & Spotify and Airplay 2 via Crestron NAX Amplifier
- (2) Dynaudio P4-W65 Rectangular Speaker 6,5"
- Apple iPad Mini 6 64GB Wi-Fi (Crestron Configured)

VIP STATEROOM

- Samsung TV LED 55" 4K
- HDMI & USB Wall Plate
- Streaming: Netflix, Disney+, etc via Smart TV & Spotify, Sirius and Airplay 2 via Bluesound Amplifier
- (2) Dynaudio P4-W65 Rectangular Speaker 6,5"
- Apple iPad Mini 6 64GB Wi-Fi (Crestron Configured)

GUEST STATEROOMS (2)

- Samsung TV LED 32" Full HD
- HDMI & USB Wall Plate
- Streaming: Netflix, Disney+, etc via Smart TV & Spotify, Sirius and Airplay 2 via Bluesound Amplifier
- (2) Dynaudio P4-W65 Rectangular Speaker 6,5"
- Apple iPad Mini 6 64GB Wi-Fi (Crestron Configured)

EXTERNAL AREA - (Aft Deck, Beach, Bow & Flybridge)

- (10) JL-Audio Waterproof Speakers 8.8"
(4) Aft Deck, (2) Bow, (4) Flybridge
- (2) JL-Audio Waterproof Speakers 7.7" on the Bow
- Powersoft Amplifier 450W/8 Channels with DSP and Dante
- Dedicated Bluesound Streaming Player for Each Area with Airplay 2 and Spotify Connect Streaming
- Audio and Lights Control via Main Salon iPad

CCTV 5-CAMERA SYSTEM

- (3) Lilin Z5R6422X3 2Mega Pixel Network Camera with IR
- (2) Lilin mini PTZ Cameras (no IR) cod. PZD6422EX3, in the Engine Room
- [2] Lilin NVR6104E 4ch - 1000M Port NVR Recorder 4ch
- LAN and WiFi NETWORK: 5G System







Electronic Navigation Equipment

- (4) GARMIN 24" Ultrawide monitors in the upper part of the console installed under a single glass touch screen
- (2) GARMIN 28" Ultrawide 16/3 monitors in the horizontal part. under a single glass touch screen
- (2) Panel with PLC + Network switches (to be installed under console)
- (1) Glass touch screen 2300x430mm (indicative measures)
- (1) Glass touch screen 2300x190mm (indicative measures)
- (4) SEASYacht Software license (GAM, Navigation Conning, Automation features, CCTV)
- (2) Software Radar + Chart plotter + Echo Sounder
- (1) GARMIN Radar GMR Fantom 24x - white
- (1) Compass MSC-10 Marine satellite compass
- (1) AIRMAR sensor transducer DST810
- (1) AIRMAR Echo sensor B60
- (1) Antenna GPS 24
- (1) VHF 215i
- (1) Sailor 7222 VHF (with DSC) Class A certified complete of antenna and remote handset
- (1) AIS 800 with cable and antenna
- (1) SIMRAD Autopilot AP70 MKII with processor AC80 and Compass Precision 9
- (1) AIRMAR Weather Station 220WX
- (2) GARMIN processor GPSMAP 8700 Black Box
- (2) Compact computer NXT Marine Type approved





Optional List Included

- Class R.I.Na. - C #HULL - MACH Y (Unrestricted Navigation - Pleasure Yacht)
- Architect Marco Casamonti CASAMONTI (Studio Archea, Florence)
- Exclusive Interior Designer Premium Package
- Integrated Bridge console (SEASYacht)
- Carbonfire Staircase
- Low Emission Windows in the Main Deck
- (10) Underwater Lights RGBW, (4) Lights on Transom & (6) Lights on Side
- Dark Metallic Paint
- Aft Control Station
- Parallel System
- Seamless Transfer: "No-Power-Blackouts" Smart Technology Prevents Blackouts When Changing from Generator to Shore Power
- Flybridge Mini Helm Station
- Gyroscopic Stabilizer Seakeeper Mod. 26. Works at Anchor (Zero Speed) & Navigation (Underway)
- AIS + Weather Station
- Customized Poltrona Frau Package (Exterior Cushions, Helm Station)
- Night Vision Camera Predisposition (Camera Not Included)
- Outside Sun Shade: (4) Aft Carbon Fiber Poles; (4) Bow Carbon Fiber Poles & (6) Flybridge Carbon Fiber Poles Complete with Micro-Holed Fabric Shade (Mesh Type)
- Electric Blind Curtains in the Main Salon
- Electric Blind Curtains in the Master, VIP, & Guest Staterooms
- Electric Black-Out Roller Shades in the Master, VIP, & Guest Staterooms
- Upgraded 47 Gallons/Hour Watermaker Instead of the Standard 34 Gallons/Hour
- Starlink Predisposition
- Portholes sensors
- Monitoring System
- 15" Monitor in the Crew Mess with Monitoring System Redundancy
- (2) External Tables with Up/Down Electric Mechanism (1) Aft Cockpit & (1) Forward Area)
- Air Compressor with 3 Connection Points; (1) Aft Area, (1) Bow Area, (1) Engine Room
- Teak on Flydeck
- Day Head in the Salon
- SCR Exhaust for Main Propulsion Engines



LAYOUT

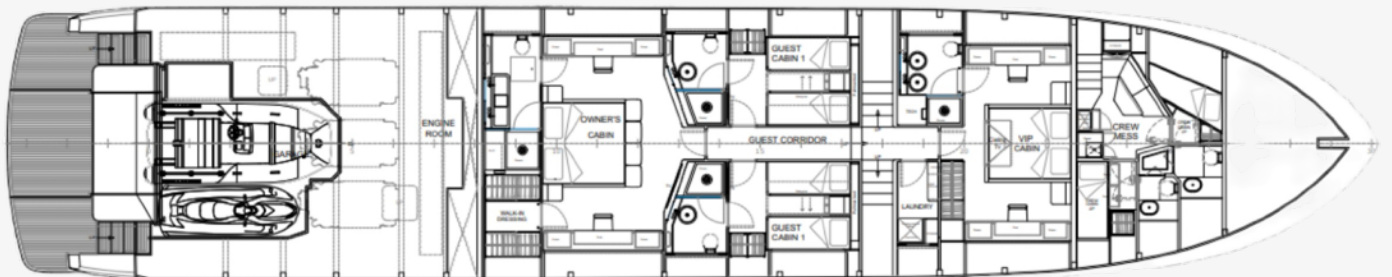
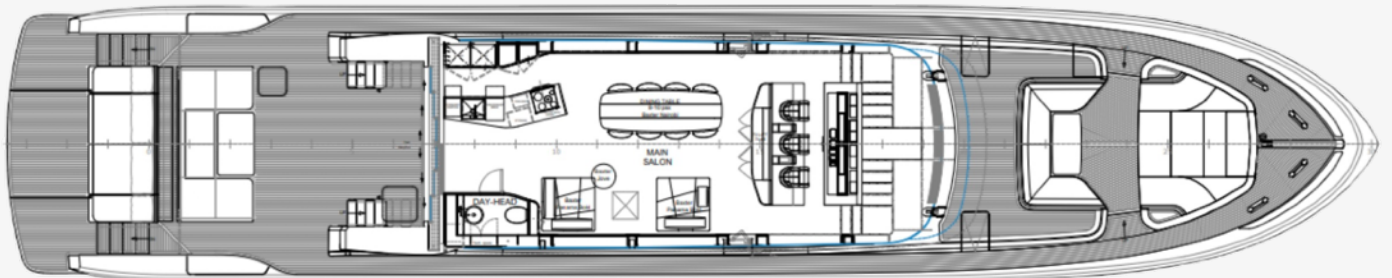
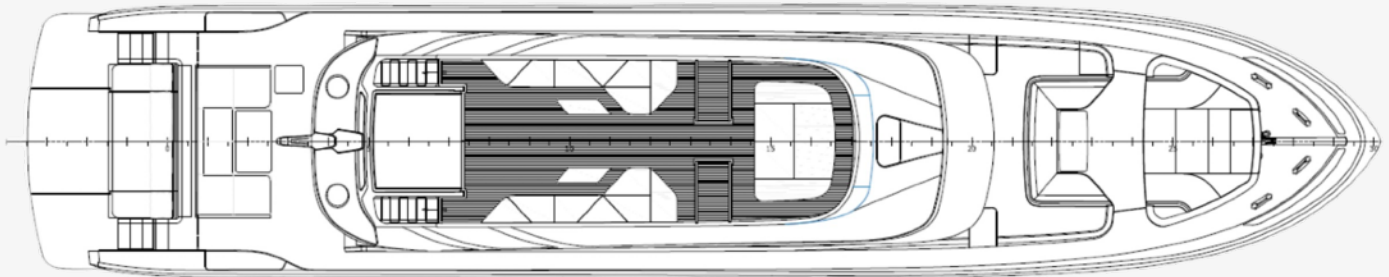
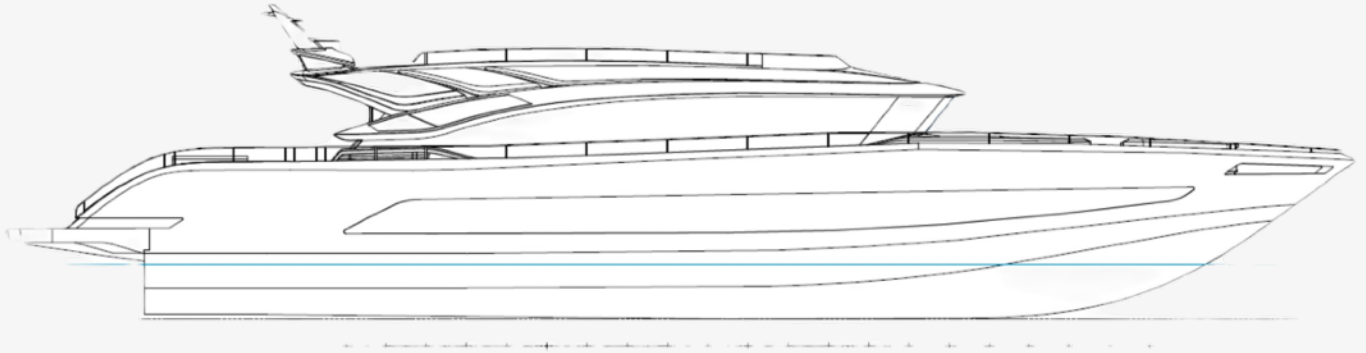



For further information or to explore the unparalleled luxury of the AB 110' 2025, please contact Barclay Tuck Yachts for all inquiries.

This exceptional vessel is offered in collaboration with Mario Burgaretta of La Rosa Dei Venti Brokers, who has invited us to co-market this stunning yacht, available directly from the AB Yachts factory.

US Buyers don't forget that although currently located in Italy, this AB 110 is ready for you to enjoy a luxurious summer cruising the Mediterranean before being easily shipped to the US or wherever your yachting adventures may take you.

Contact us today to schedule a private viewing and seize the opportunity to own this masterpiece of Italian craftsmanship!

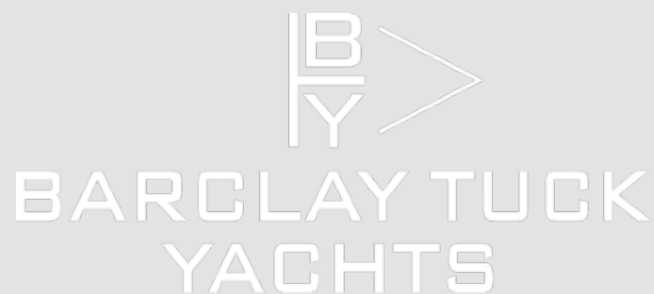

CONTACT TODAY - BARCLAY FISKE TUCK

C: 858-699-7637

E: BARCLAYTUCK@GMAIL.COM